

RECORDING REQUESTED BY:

AND WHEN RECORDED MAIL TO:

Prescott College
220 Grove Ave.
Prescott, AZ 86301

SPACE ABOVE THIS LINE FOR RECORDER'S USE

QUIT CLAIM DEED

For consideration of Ten Dollars, and other valuable considerations, I or we,

City of Prescott, an Arizona municipal corporation

hereby quit-claim to

Prescott College, Inc., an Arizona Nonprofit Corporation

all right, title or interest in the following real property situated in Yavapai, County, ARIZONA:

See Exhibit A attached hereto and made a part hereof.

Affidavit of Value exempt under ARS 11-1134 A4

Dated:

City of Prescott, a municipal corporation

Greg L. Mengarelli, Mayor

State of Arizona
County of Yavapai

} SS:

On _____, 20__, before me personally appeared Greg L. Mengarelli, Mayor of the City of Prescott,
an Arizona municipal corporation, whose identity was proved to me on the basis of satisfactory evidence to be the
person whose name is subscribed to this document and who acknowledged that he/she signed the above/attached
document in his or her authorized capacity (ies)

(Seal)

Notary Public
Commission Expires: _____

March 26, 2019

LEGAL DESCRIPTION FOR
SAM'L HILL
PARCEL C

That portion of G.L.O. Lot 7 of Section 33, Township 14 North, Range 2 West of the Gila and Salt River Meridian, Yavapai County, Arizona, more particularly described as follows:

Commencing at the Shaft in hand hole marking the intersection of Granite Street and Willis Street, as depicted on said City of Prescott Original Townsite, as recorded in Book 4 of Maps and Plats, Page 22, Records of Yavapai County, Arizona, from which the Brass Cap in hand hole marking the intersection of Montezuma Street and Willis Street, as depicted on said City of Prescott Original Townsite bears South 88°36'23" East, a distance of 423.88 feet;

Thence North 00°53'09" East, along the monument line of said Granite Street, a distance of 616.11 feet to the Northerly right-of-way line of Sheldon Street as depicted on said City of Prescott Original Townsite;

Thence North 88°37'52" West, along said Northerly right-of-way line, a distance of 40.00 feet to the Northerly prolongation of the Westerly right-of-way line of said Granite Street, said point being the Southeasterly Corner of that certain parcel of land described as Parcel 1 in Book 3499 of Official Records, Page 862, Records of Yavapai County, Arizona;

Thence North 00°51'51" East, along said Northerly prolongation and the Westerly line of said Parcel 1, a distance of 130.05 feet to the Northeast Corner of said Parcel 1;

Thence North 88°38'48" West, along the Northerly line of said Parcel 1, a distance of 180.00 feet to the Easterly line of that certain parcel of land described in Book 158 of Deeds, Page 309, Records of Yavapai County, Arizona;

Thence South 00°52'35" West, along said Easterly line, a distance of 45.45 feet to the Old Fort Whipple Reservation line as it existed in 1871, 1872 and 1873, as shown by the Official Plat of Township 14 North, Range 2 West of the Gila and Salt River Meridian, as filed with the General Land Office November 7, 1871, said point being the True Point of Beginning;

Thence South 84°49'11" East, along said Reservation Line, a distance of 30.09 feet to the Northwest Corner of Lot 22 on said Reservation line, as depicted in Book 191 of Land Surveys, Page 51, Records of Yavapai County, Arizona;

Thence South 00°52'35" West, along the West line of said Lot 22, a distance of 82.55 feet to a point on the Northerly line of said Sheldon Street;

Thence North 88°37'52" West, along said Northerly line, a distance of 30.00 feet to the Easterly line of said certain parcel of land described in Book 158 of Deeds, Page 309;

N:\01\0317701\Admin\Legal Descriptions\G-LG-HILL-PCLC.docx

Page 1 of 2

Legal Description for
Sam'l Hill
Parcel C
March 26, 2019

Thence North $00^{\circ}52'35''$ East, along said Easterly line, a distance of 84.55 feet to the True Point of Beginning.

Containing 2,507 Square Feet or 0.058 Acres, more or less.

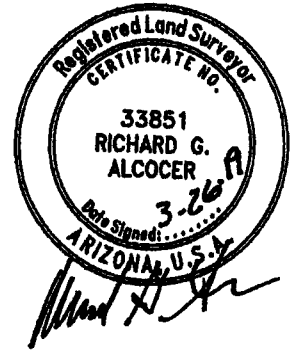



BOOK 158
OF DEEDS
PAGE 309

FORT WHIPPLE
RESERVATION LINE

TRUE POINT OF
BEGINNING

WESTERLY
LINE, LOT 22

PARCEL 1
BOOK 3499
PAGE 862

SHELDON STREET

GRANITE STREET

ORIGINAL TOWNSITE
CITY OF PRESCOTT
BOOK 4 OF MAPS & PLATS
PAGE 22

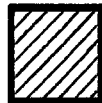

= PARCEL C

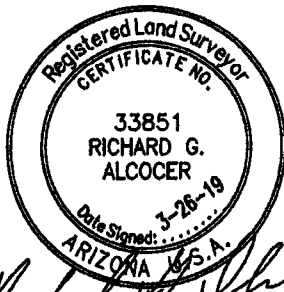

POINT OF COMMENCEMENT

WILLIS
STREET

SCALE 1" = 60'

EXHIBIT

4550 North 12th Street
Phoenix, Arizona 85014
Phone 602-264-6831
<http://www.cvlci.com>

SAM'L HILL

PARCEL C



1 OF 1